

Ruby: Manage Screen

The manage view allows you to open, delete or upload files as well as organise them, we'll start by uploading a file.

Uploading a file

In Ruby switch to the manage screen and drag and drop the file(s) onto the dropzone:

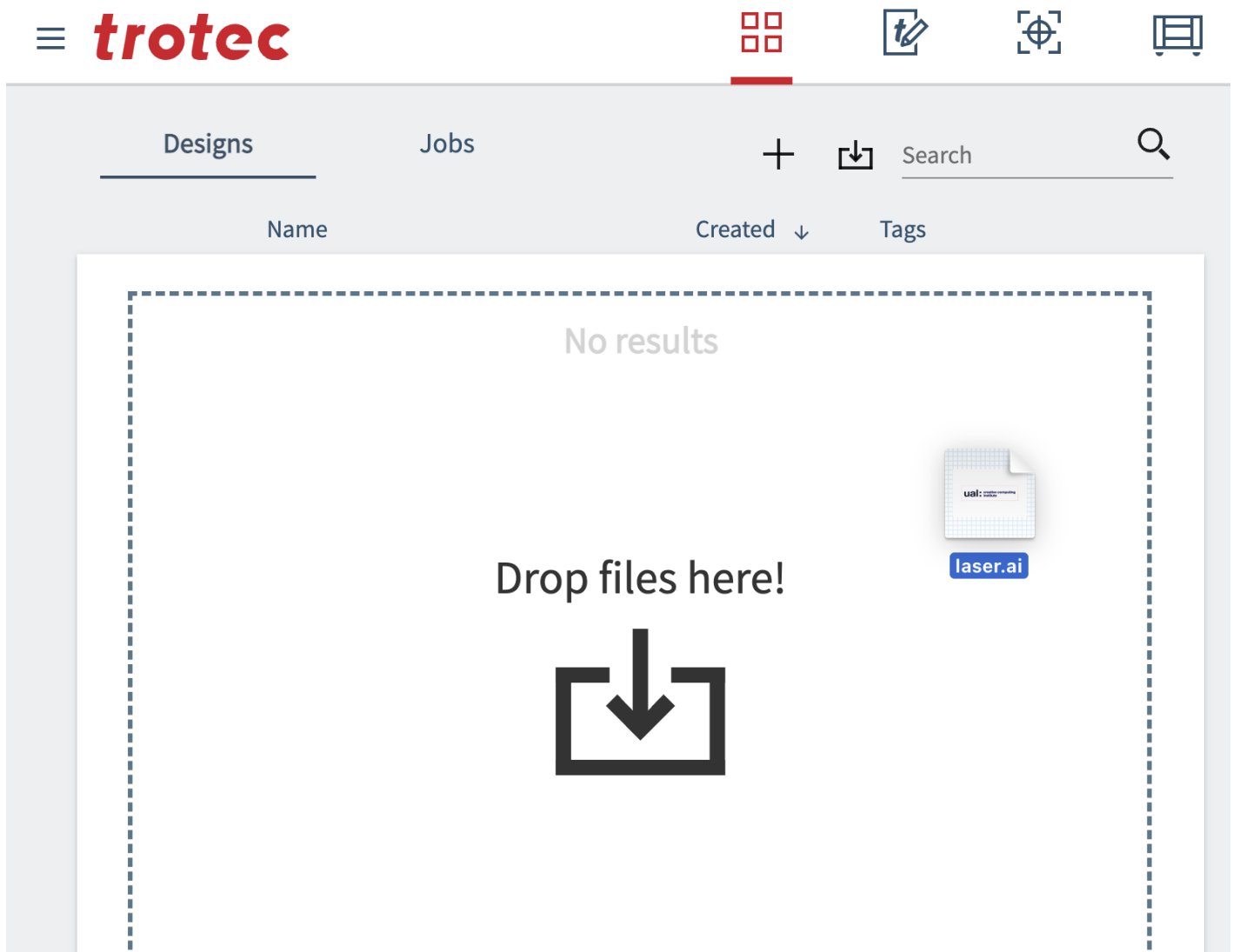



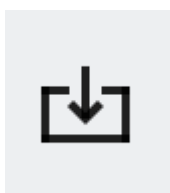

Alternatively click the "Import File" icon and find the file(s) in the pop up dialog:



Open a design

After your file is uploaded to Ruby it becomes part of a new design. You can see a small preview in your list of designs that you can open in the [Design Screen](#) by double clicking, delete or download by clicking the relivent icons next to the design.

Designs		Jobs			+ 		Search 
<input type="checkbox"/>	Name	Created	↓	Tags			
	laser.ai	19/01/2022, 21:29		(no tags)			

Revision #7
Created 28 February 2022 23:06:32 by Tom Lynch
Updated 21 December 2023 23:41:07 by Tom Lynch